



SPARK-PROOF MANUAL CHAIN HOISTS SLAS



SLAS hoist



Spark-proof components

The **SLAS** manual chain hoist is the best as versatility and features matching requirements of hazardous areas

High performance equipment

- capacity up to 40T
- steel bod- bronze cover of the gear
- solid bronze sprocket pocket wheel
- bronze ratched break wheel
- bronze chain guides
- stainless steel AISI 316 hand chain bronze wheels on trolleys
- high quality finish

On request

- stainless steel lifting chain AISI 316
- stainless steel AISI 316 hook block
- stainless steel bearings
- stainless steel frames for HT hoists
- sliding assembly of trolley wheels for easy erection
- load limitor
- articulated trolley for curved beams
- stationary brake on trolley



SPARK-PROOF MANUAL CHAIN HOISTS SLAS



Spark-proof manual trolley-hoist with stationary brake



Spark-proof trolley-hoist

SPARK-PROOF MANUAL CHAIN HOISTS SLAS

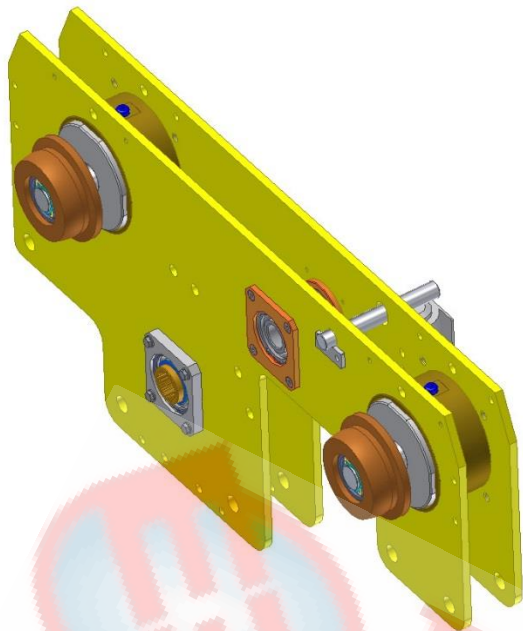

Easy erection of trolley





SPARK-PROOF MANUAL CHAIN HOISTS SLAS

STEEL CHAIN

Special Bull chain of high strength, hardened resistant alloyed steel galvanized surface treatment. Stainless steel chain of high grade, AISI 316, is available as well, on request or when high-tech execution is required

BRAKE

The brake consists in 4 quadruple-start thread shaft which controls the axial moving of the flange closing the fiber discs when toothed bronze wheel is acted by the dropping load

CHAIN COLLECTOR BOX (under request)

Suspended to the hoist frame, it is made of galvanized steel or stainless steel

CHAIN DRIVE

The unit assembly consists of the chain, the sprocket pocket wheel, the epicycloidal gear and the chain guide roll. The high quality alloyed bronze is used for manufacturing of parts in order to avoid steel/steel contact

BOTTOM HOOK BLOCK

Hoists up to 3000KG are supplied with single chain fall for improved ergonomic handling of the hook

OVERLOAD DEVICE (under request)

Special clutch system is applied, combine with the brake in order to avoid overloading of the hoist

SPARK-PROOF MANUAL CHAIN HOIST SL-AS HOOK/HOOK EXECUTION



SPARK-PROOF MANUAL CHAIN HOISTS SLAS

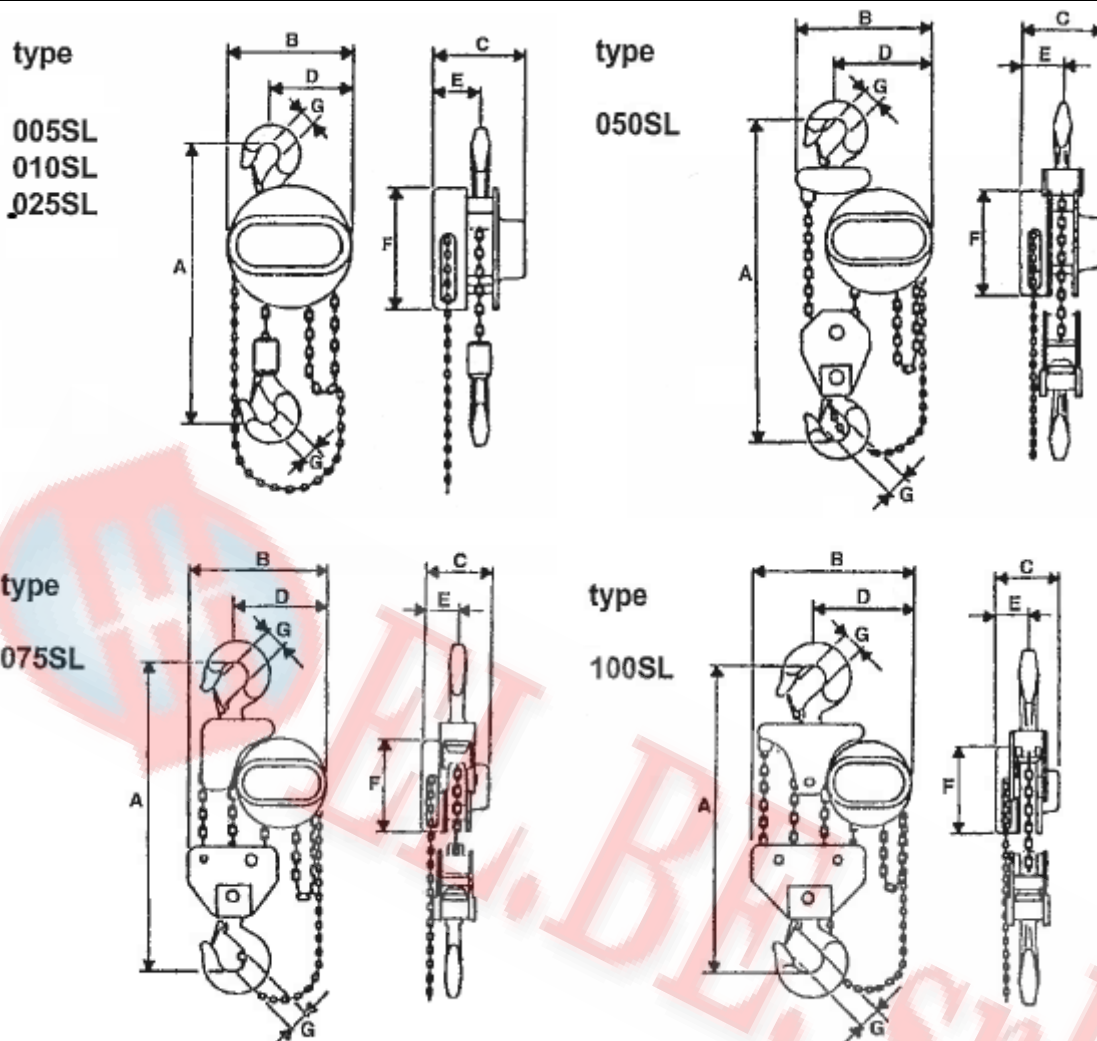

CAPACITY	TYPE	FALLS	HOOK PATH	HAND EFFORT	LIFTING CHAIN	HAND CHAIN	A	B	C	D	E	F	G	Weight
Kg		n°	m	daN	mm	mm	mm	mm	mm	mm	mm	mm	mm	Kg
500	SL005AS	1	3	21	5x15	5x18,5	300	148	148	80	87	133	24	9
1000	SL010AS	1	3	30	6x18	5x18,5	335	175	167	82	97	156	29	13
2000	SL020AS	1	3	32	8x24	5x18,5	395	203	194	100	111	182	35	20
2500	SL025AS	1	3	33	10x28	5x18,5	420	255	195	172	98	255	35	30
3000	SL030AS	1	3	38	10x30	5x18,5	420	255	195	172	98	255	35	36
5000	SL050AS	2	3	33	10x28	5x18,5	655	340	195	233	98	255	42	55
7500	SL075AS	3	3	34	10x28	5x18,5	720	405	195	263	98	255	51	78
10000	SL100AS	4	3	35	10x28	5x18,5	830	495	195	308	98	255	58	104

SPARK-PROOF MANUAL CHAIN HOIST SL-AS



SPARK-PROOF MANUAL CHAIN HOISTS SLAS

HOOK/HOOK EXECUTION

type
125SL

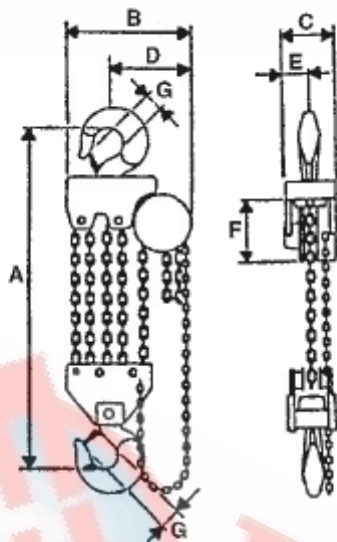

type
150SL

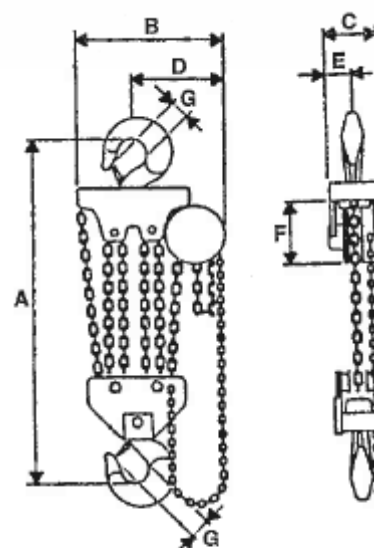

type
200SL

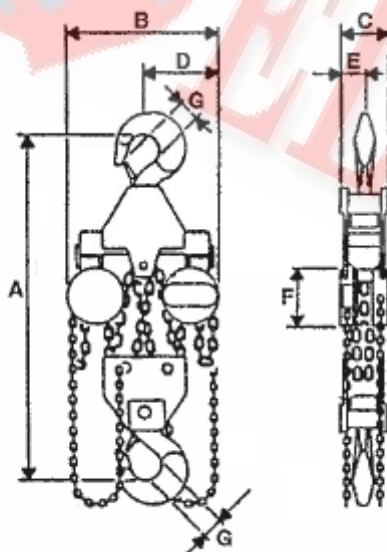

type
300SL

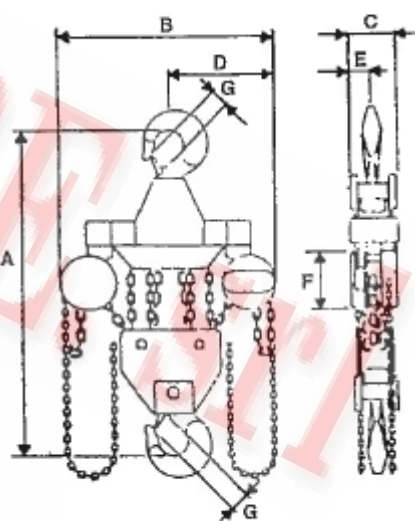

CAPACITY	TYPE	FALLS	HOOK PATH	HAND EFFORT	LIFTING CHAIN	HAND CHAIN	A	B	C	D	E	F	G	Weight
Kg		n°	m	daN	mm	mm	mm	mm	mm	mm	mm	mm	mm	Kg
12500	SL125AS	5	3	36	10x28	5x18,5	980	585	190	350	98	255	80	160
15000	SL150AS	6	3	37	10x28	5x18,5	1200	630	190	385	98	255	80	250
20000	SL200AS	8	3	35x2	10x28	5x18,5	1430	700	256	322	128	255	94	345
30000	SL300AS	12	3	36x2	10x28	5x18,5	1600	940	370	470	185	255	94	550



SPARK-PROOF MANUAL CHAIN HOISTS SLAS

SPARK-PROOF MANUAL CHAIN HOIST SL-ASCC COMPACT EXECUTION

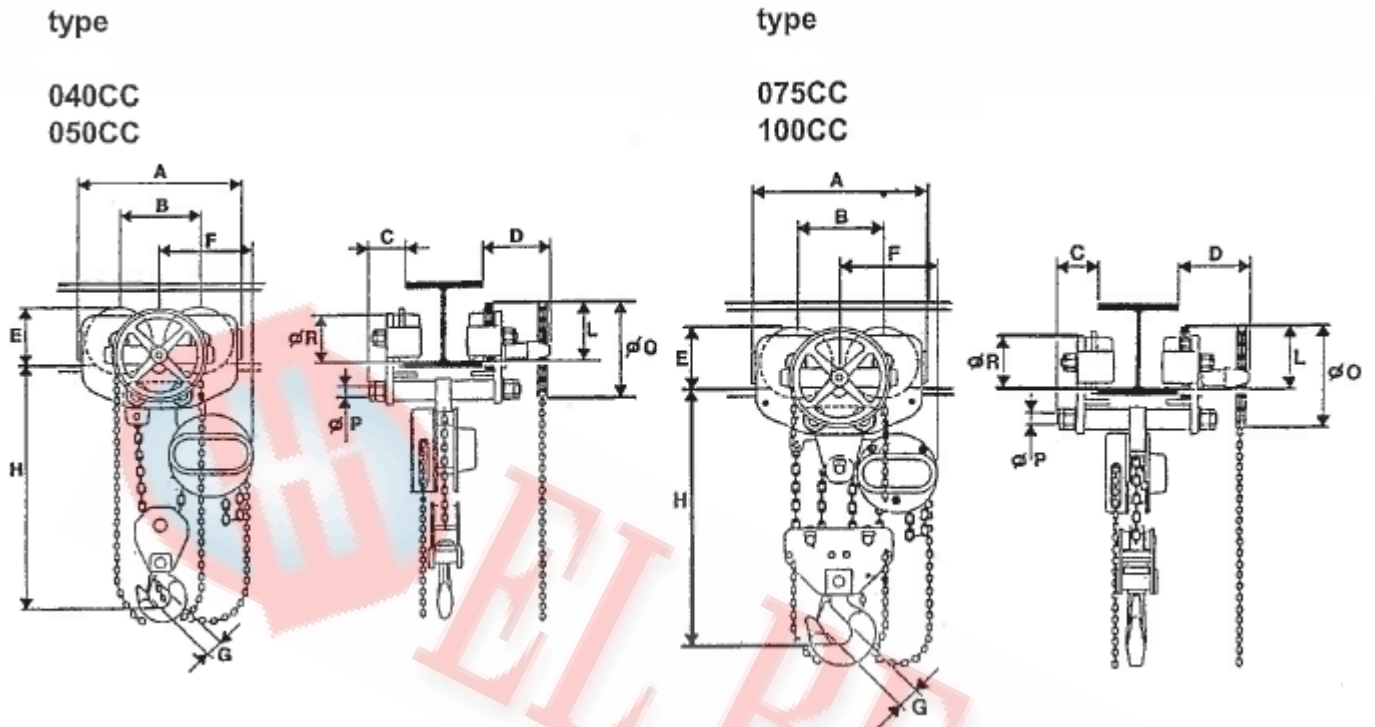

CAPACITY	TYPE	FALLS	HOOK PATH	HAND EFFORT	LIFTING CHAIN	HAND CHAIN	A	B	C	D	E	F	G	Weight
Kg		n°	m	daN	mm	mm	mm	mm	mm	mm	mm	mm	mm	Kg
4000	SL040ASCC	2	3	27	10x28	5x18,5	445	225	88	187	153	240	42	140
5000	SL050ASCC	2	3	33	10x28	5x18,5	445	225	88	187	153	240	42	140
7500	SL075ASCC	3	3	24	10x28	5x18,5	550	270	120	192	194	320	51	240
10000	SL100ASCC	4	3	35	10x28	5x18,5	550	270	120	192	194	320	58	270



SPARK-PROOF MANUAL CHAIN HOISTS SLAS

SPARK-PROOF MANUAL CHAIN HOIST SL-ASCC COMPACT EXECUTION

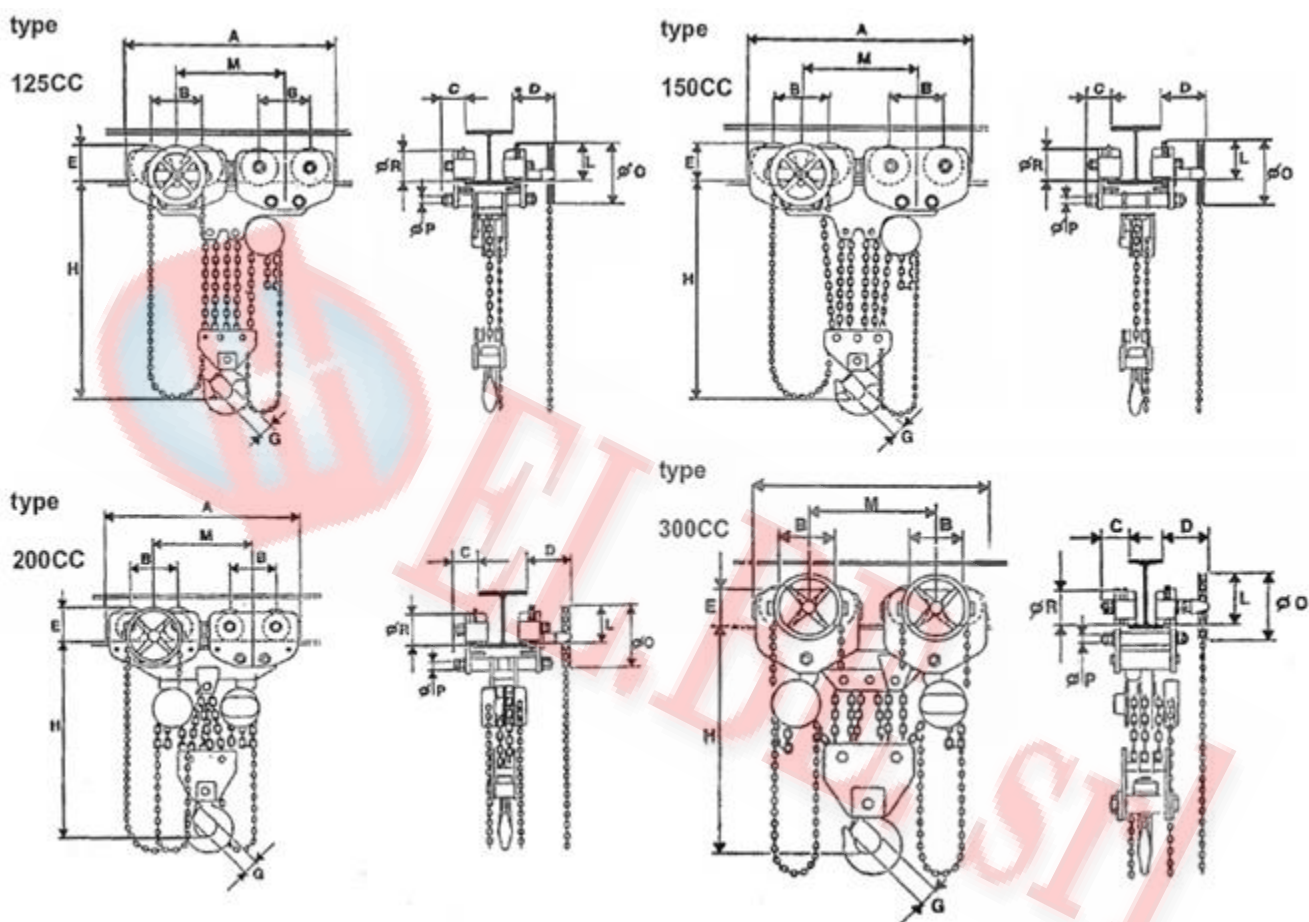

CAPACITY	TYPE	FALLS	HOOK PATH	HAND EFFORT	LIFTING CHAIN	HAND CHAIN	A	B	C	D	E	F	G	Weight
Kg		n°	m	daN	mm	mm	mm	mm	mm	mm	mm	mm	mm	Kg
12500	SL125ASCC	5	3	36	10x28	5x18,5	550	225	90	180	153	-	80	410
15000	SL150ASCC	6	3	37	10x28	5x18,5	1100	270	120	192	194	-	80	610
20000	SL200ASCC	8	3	35x2	10x28	5x18,5	1150	270	120	192	194	-	94	720
30000	SL300ASCC	12	3	36x2	10x28	5x18,5	1330	296	140	248	320	-	94	950



SPARK-PROOF MANUAL CHAIN HOISTS SLAS

SPARK-PROOF MANUAL CHAIN HOIST SL-AS HAND PUSH TROLLEYS

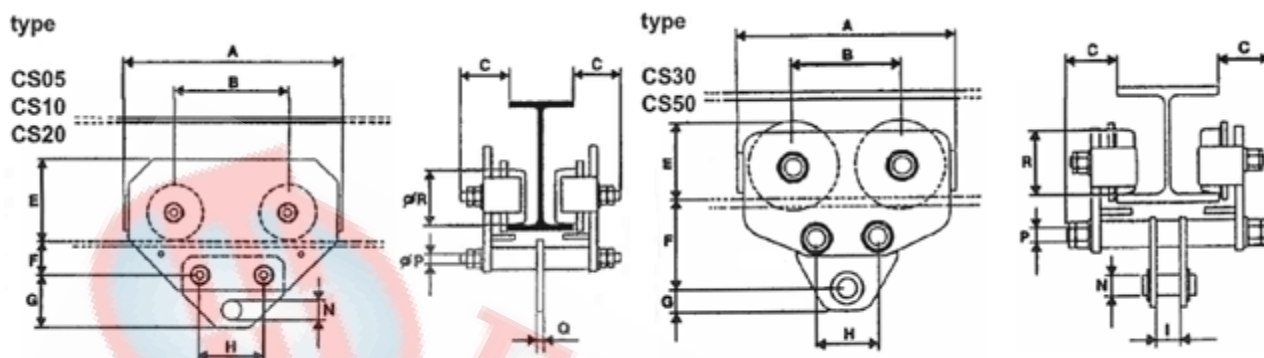

CAPACITY	Type	Weight	HAND CHAIN	A	B	C	D	E	F	G	H	I	L	N	O	P	R	Min Radius
Kg		Kg	mm	mm	mm	mm	mm	mm	mm	mm	mm	mm	mm	mm	mm	mm	mm	mm
500	CS005AS	11	5x18,5	268	135	50	150	99	76	20	70	-	105	35	140	14	70	1000
1000	CS010AS	15	5x18,5	276	135	60	155	99	81	34	80	-	105	40	140	16	70	1000
2000	CS020AS	19	5x18,5	280	135	65	155	105	100	42	150	-	105	40	140	20	70	1000
3000	CS030AS	40	5x18,5	370	180	78	160	130	130	33	110	40	160	30	220	24	100	1800
5000	CS050AS	66	5x18,5	445	225	88	187	138	168	45	120	50	198	40	270	30	125	2000



SPARK-PROOF MANUAL CHAIN HOISTS SLAS

SPARK-PROOF MANUAL CHAIN HOIST SL-AS HAND MECHANICAL TROLLEYS

type

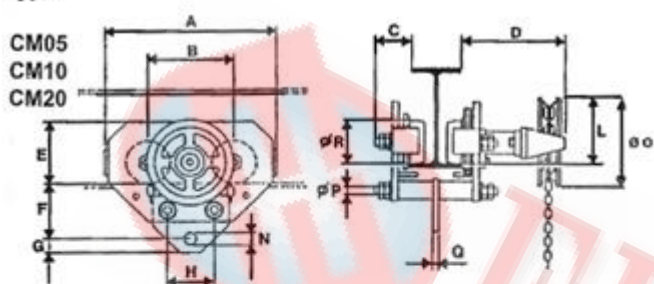

type

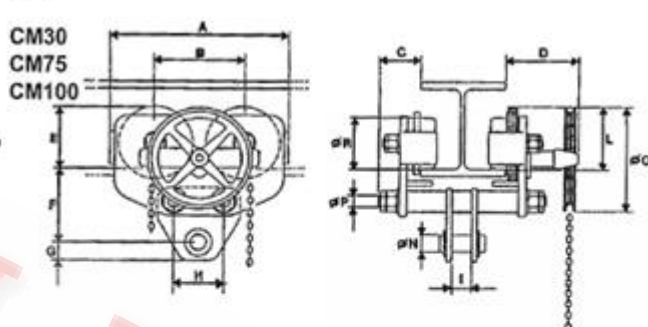

type

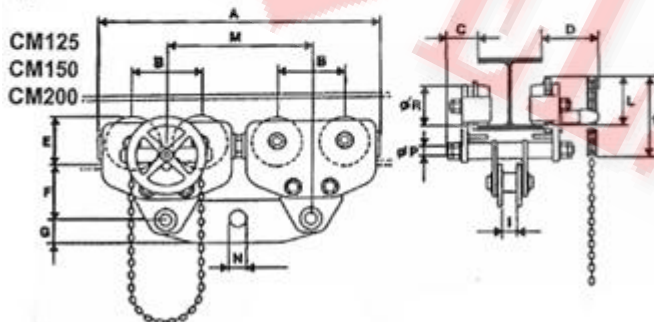

type

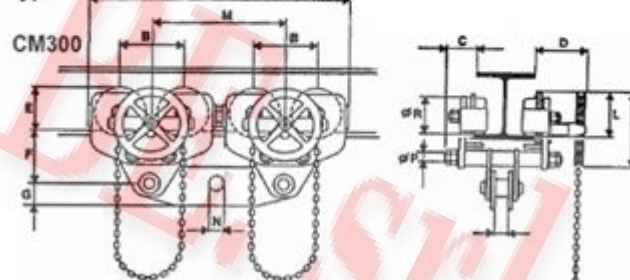

CAPACITY	Type	Weight	HAND CHAIN	A	B	C	D	E	F	G	H	I	L	N	O	P	R	Min Radius
Kg		Kg	mm	mm	mm	mm	mm	mm	mm	mm	mm	mm	mm	mm	mm	mm	mm	mm
500	CM005AS	16	5x18,5	268	135	50	150	99	76	20	70	-	105	35	140	14	70	1000
1000	CM010AS	18	5x18,5	276	135	60	155	99	81	34	80	-	105	40	140	16	70	1000
2000	CM020AS	23	5x18,5	280	135	65	155	95	100	42	150	-	105	40	140	20	70	1000
3000	CM030AS	45	5x18,5	370	180	78	160	130	130	33	110	40	160	30	220	24	100	1800
5000	CM050AS	80	5x18,5	445	225	88	187	153	168	45	120	50	198	40	270	30	125	2000
7500	CM075AS	160	5x18,5	550	270	120	192	194	220	55	150	60	240	50	320	39	160	2800
10000	CM100AS	160	5x18,5	550	270	120	192	194	220	55	150	60	240	50	320	39	160	2800
12500	CM125AS	210	5x18,5	945	225	90	180	153	168	95	120	75	203	65	320	30	125	4000
15000	CM150AS	340	5x18,5	1100	270	120	192	194	220	90	150	75	228	65	390	39	160	5100
20000	CM200AS	380	5x18,5	1150	270	120	192	194	250	120	150	100	228	80	390	39	160	5500



SPARK-PROOF MANUAL CHAIN HOISTS SLAS

30000	CM300AS	500	5x18,5	1330	296	140	248	320	290	150	380	100	335	95	390	48	170	5900
-------	---------	-----	--------	------	-----	-----	-----	-----	-----	-----	-----	-----	-----	----	-----	----	-----	------

